

# SM-30T

Driver unit for waterproof exponential speaker

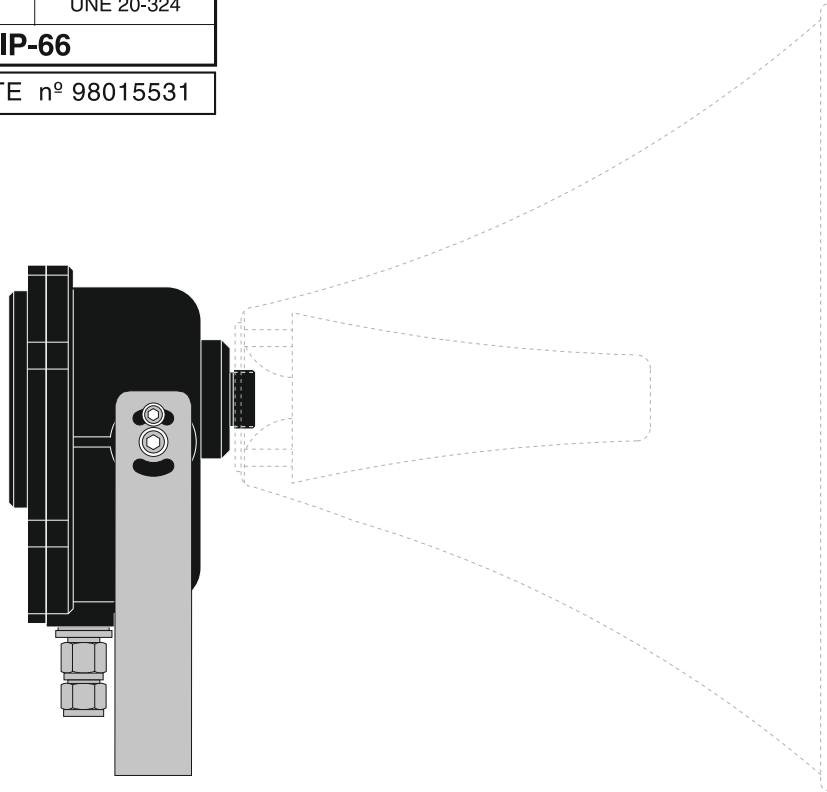

DEGREE OF CASING PROTECTION		
STANDARDS	EN 60529	UNE 20-324
IP CODE	<b>IP-66</b>	
L.G.A.I. CERTIFICATE nº 98015531		



## TECHNICAL FEATURES

- Rated power:	30 W.	- Impedance:	16 Ω / 100 V. line transformer.
- Sensitivity (*):	107 dB 1 W/1 kHz/1 m.	- Cable input:	1 3/4" NPT cable gland.
- Frequency range:	150 to 10000 Hz.	- Weight:	5.6 Kg.

Power selection (100 V. line): 30 / 15 / 7.5 / 3 W.

(\* ) with BG-50/E horn.

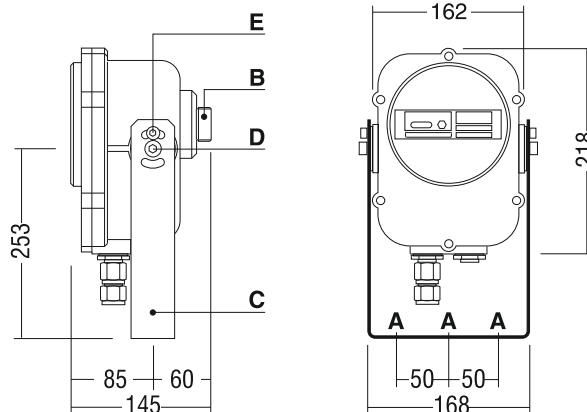

- A = 3 FASTENING SCREWS**  
( Ø11 mm.)
- B = HORN COUPLING THREAD**  
RW 1" 3/8" (18 threads)
- C = BRACKET**
- D = VERTICAL ORIENTATION SCREW**
- E = BRACKET SCREW**

**MATERIAL = CAST ALUMINIUM**

MEASUREMENTS IN MILLIMETRES  
SCREWS: STAINLESS STEEL.



EQUIPOS Y SISTEMAS MEGAFONÍA / INTERCOM • PUBLIC ADDRESS SYSTEMS

**UNIÓN DESARROLLOS ELECTRÓNICOS**

Tel.: +34 934 772 854 / +34 609 914 787 • ude@udeaudio.com • BARCELONA - SPAIN

[www.udeaudio.com](http://www.udeaudio.com)

rev.0 | 610.113a | 1 / 2

## DESCRIPTION

The SM-30T 30 W RMS watertight driver has an impedance adaptation transformer for 100 V constant voltage audio-frequency lines, which can also be used with a 70.7 V and 50 V line (see power range table), and can also be connected to low-impedance ( $16\ \Omega$  30 W).

The surround casing is made of aluminium alloy and the screws are made of stainless steel. It is connected to exponential horns with RW 1" 3/8 threads (16 wires per inch).

## INSTALLATION

Its steel bracket means it can be placed to face in any direction, and can also be fixed permanently using two screws which are provided for this purpose.

The cable is run in through a 3/4" thread NPT cable gland. If necessary, several speakers can be connected in parallel by removing a threaded obturating plug, and fitting a second stuffing box in its place, thereby simplifying installation.

## APPLICATIONS

For indoor and outdoor public address installations, as well as in industrial and marine environments.

Certificate: L.G.A.I. n°98015531

Valid for all EEC countries, and others.

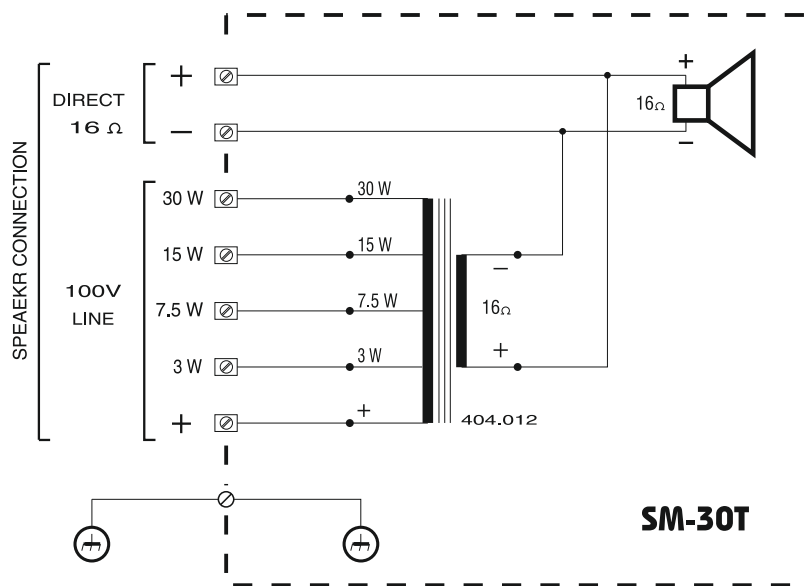

	30	15	7.5	3
100 V. L.	30	15	7.5	3
70.7 V. L.	15	7.5	3	1.5
50 V. L.	7.5	3	1.5	-

## TYPICAL INSTALLATION

