

AP-820

20W Acoustic box



**Two-ways acoustic box
for voice and music diffusion**



CONNECTION

UDE		AP-820	
20w	10w	5w	2,5w
500 Ω	1K	2K	4K
L. 100 V.			
		MADE IN SPAIN	CE

The acoustic box AP-820 is designed for use in sound systems that require a high degree of intelligibility of the speech and good music sound.

It combines a very balanced, a esthetic and electroacoustic design with great ease of installation as well as positioning thanks to a ball and socket joint.

Built in plastic ABS, with a propylene loudspeaker and aluminium mode mounting bracket, it is highly suitable for a wide range of uses. These include a changing room, a swimming pool and other locals with high humidity.

TECHNICAL FEATURES

- Woofers:	5" (propylene).	- Acoustic pressure (1m / 1W / 1 kHz):	88 dB.
- Tweeter:	1/2" (mylar).	- Material:	Plastic ABS / metal.
- Power:	20 - 10 - 5 - 2,5 W rms. L100V.	- Colour:	Black.
- Power selection:	Rotatory switch selector.	- Size:	146 x 235 x 144 mm.
- Wiring:	Spring terminals.	- Weight:	1,890 Kgs.
- Frequency range:	120 Hz to 20 KHz.	- Mounting bracket included.	



EQUIPOS Y SISTEMAS MEGAFONÍA / INTERCOM • PUBLIC ADDRESS SYSTEMS

UNIÓN DESARROLLOS ELECTRÓNICOS

Tel.: +34 934 772 854 / +34 609 914 787 • ude@udeaudio.com • BARCELONA - SPAIN

www.udeaudio.com

rev.0 | 610.295a | 1 / 2

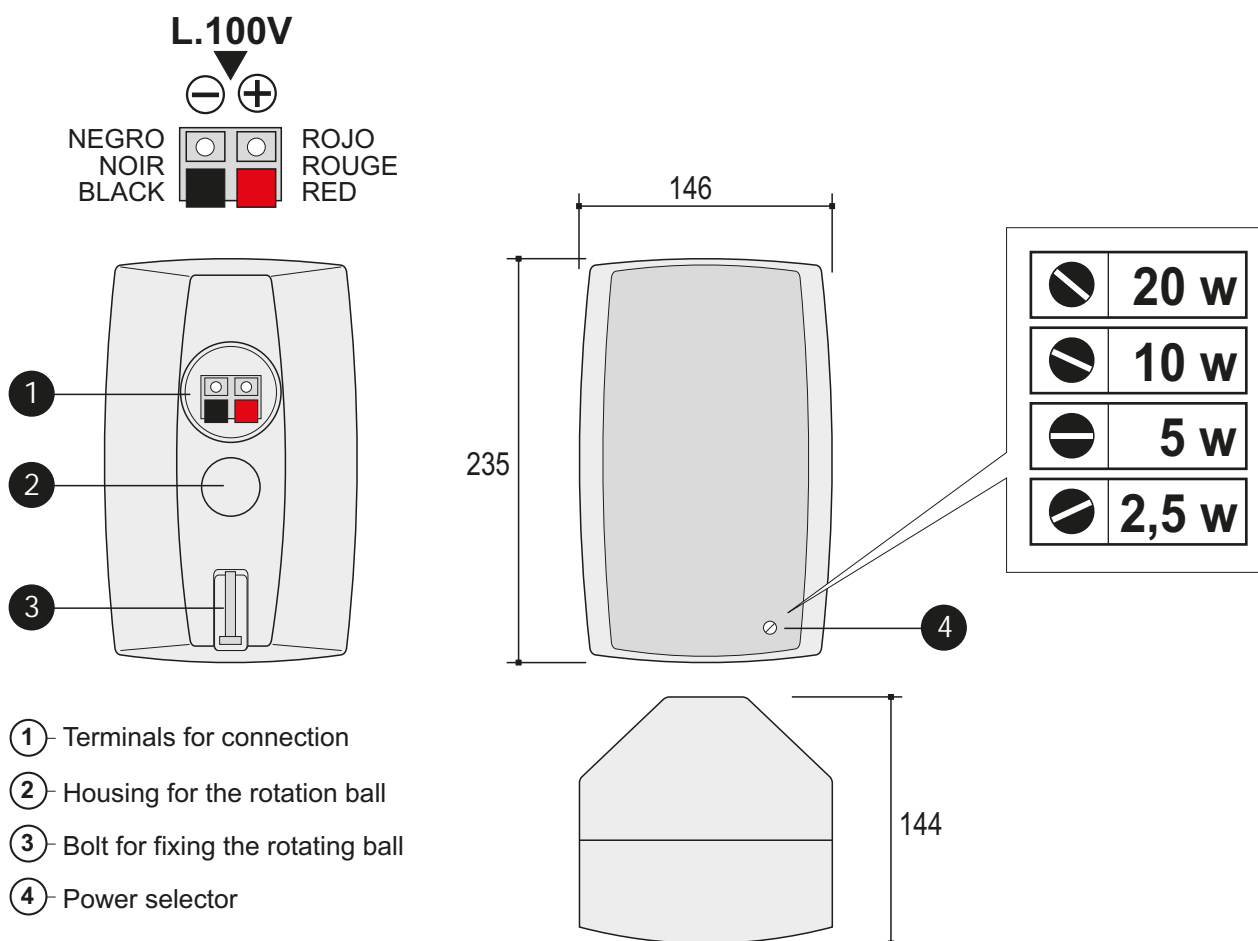

ASSEMBLING

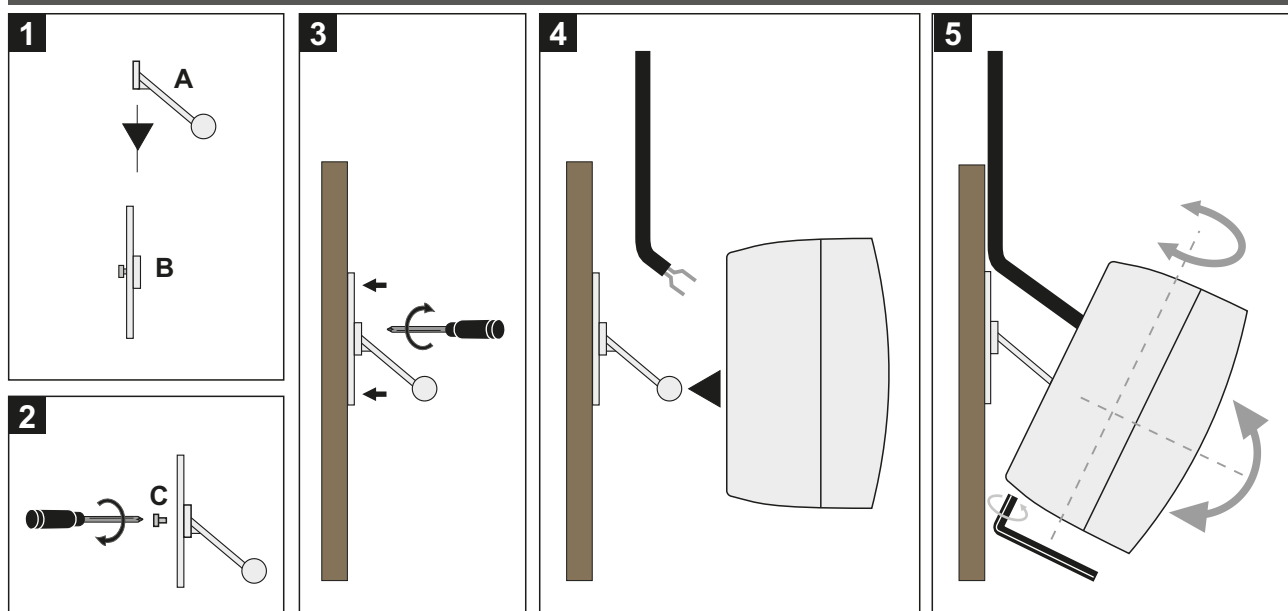

- 1 Assemble pieces A and B.
- 2 Fix both pieces with screw C.
- 3 Fix the mounting bracket in its desired position.
- 4 Connect the loudspeaker line (L 100V) in its socket. Insert the loudspeaker at the end of the rotating arm.
- 5 Direct the loudspeaker and fast the bolt D.